

LUXURY FRAMELESS 2 SIDED SHOWERS



Pictured Above - Stellar
Luxury 12x1 LH Silva
Door
Flat Wall
SKU 242920



Pictured Above - Stellar Luxury 12x9 RH Black
Door Flat Wall
SKU 318634

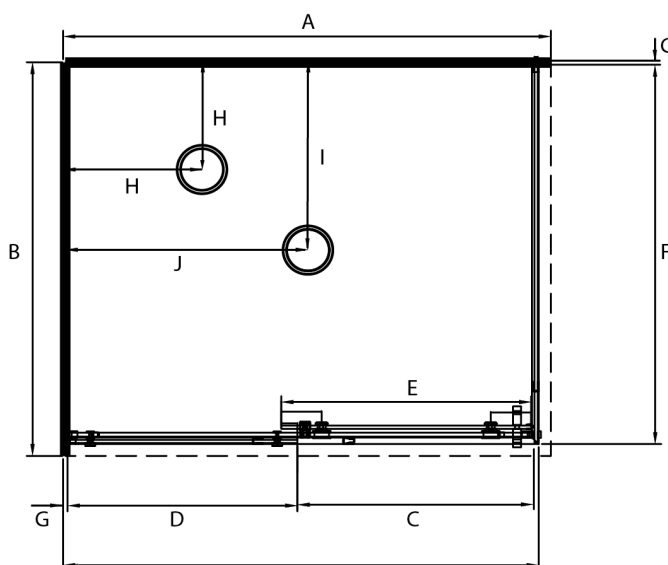

DESCRIPTION

The Stellar Luxury frameless range of showers can be purchased as a complete shower cubicle including Acrylic Tray, Wall Liner and Door pack.

The Door pack can also be purchased as an individual item for a tiled floor and wall installation.

SEE TILE SHOWER LAYOUT FOR SETOUT DIMENSIONS

The Door is NOT reversible.

FEATURES

- Low profile tray with 40mm upstand
- 2000mm high glass 8mm Safety Glass
- Total OVERALL height 2060mm
- Door closes to finished wall
- Minimalistic extrusion allows adjustment to wall and floor
- No silicone joints required for glass
- High quality stainless / alloy fittings

LEGEND

Dimension	Description	Shower Size					
		1200 x 800	1200 x 900	1200 x 1000	1400 x 900	1400 x 1000	1600x900
A	Tray Width External Dimension	1200mm	1200mm	1200mm	1400mm	1400mm	1600mm
B	Tray Depth External Dimension	800mm	900mm	1000mm	900mm	1000mm	900mm
C	Door Opening Dimension +/- 10mm	540mm	540mm	540mm	640mm	640mm	740mm
D	Fixed Panel Dimension	562mm	562mm	562mm	662mm	662mm	762mm
E	Door Panel Dimension	618mm	618mm	618mm	718mm	718mm	818mm
F	Return Panel Dimension	758mm	858mm	958mm	858mm	958mm	858mm
G	Gib Board Liner Thickness +/-1.5mm	12.5mm	12.5mm	12.5mm	12.5mm	12.5mm	12.5mm
H	Corner Waste Position	250mm	250mm	250mm	250mm	250mm	N/A
I	Centre Waste Position (Depth from Framing)	N/A	450mm	500mm	N/A	N/A	450mm
J	Centre Waste Position (Width from Framing)	N/A	600mm	600mm	N/A	N/A	800mm

ORDERING CODES

Product Description	SKU CODE					
	1200 x 800	1200 x 900	1200 x 1000	1400 x 900	1400 x 1000	1600x900
Complete Cubicle Silva Flat Wall LH	295544	243632	242920	SL14X9SIFWLH	242923	2013806
Complete Cubicle Silva Flat Wall RH	295546	244311	242921	SL14X9SIFWRH	242924	2013808
Complete Cubicle Black Flat Wall LH	318631	318633	318629	SL14X9BLFWLH	318635	2013809
Complete Cubicle Black Flat Wall RH	318632	318634	318630	SL14X9BLFWRH	318636	2013810
Complete Cubicle White Flat Wall LH	2005384	2005388	2005392	SL14X9WHFWLH	2005396	2013811
Complete Cubicle White Flat Wall RH	2005385	2005389	2005393	SL14X9WHFWRH	2005397	2013812
Centre waste option for tray	N/A	119561	119561	N/A	N/A	N/A
Tray Only Corner Waste White LH	320636	320638	320640	TFS14X9LHCNR	320642	N/A
Tray Only Corner Waste White RH	320637	320639	320641	TFS14X9RHCNR	320643	N/A
Tray Only Centre Waste White LH	N/A	353352	TFS12X10LHCW	N/A	N/A	353344
Tray Only Centre Waste White RH	N/A	353353	TFS12X10RHCW	N/A	N/A	353345
Liner Only Flat Wall 2M 2 sided	LB12X8FW2S2M	LB12X9FW2S2M	LB12X1FW2S2M	LB14X9FW2S2M	LB14X1FW2S2M	LB16X9FW2S2M
Door / Return Pack 2M SILVA LH	2005412	2005414	2005416	D14DX9RSILH2MST	2005418	2013813
Door / Return Pack 2M SILVA RH	2002413	2005415	2005417	D14DX9RSIRH2MST	2005419	2013814
Door / Return Pack 2M BLACK LH	318647	318649	318645	D14DX9RBLH2MST	318651	2013815
Door / Return Pack 2M BLACK RH	318648	318650	318646	D14DX9RBLRH2MST	318652	2013816
Door / Return Pack 2M WHITE LH	2005400	2005402	2005404	D14DX9RWHLH2MST	2005406	2013817
Door / Return Pack 2M WHITE RH	2005401	2005403	2005405	D14DX9RWHLH2MST	2005407	2013818

WARRANTY INFORMATION

All bathroomware products supplied by Fibre Systems carry our Quality Assurance and Product Warranty. We use the highest quality materials available and manufacture these in accordance with New Zealand specifications and requirements to ensure that all products are fit for the intended purpose for which they are designed. Our customer's peace of mind is of paramount importance to us.

Warranty Periods

Baths	10 years
Showers	10 years
Shower Screens and Doors	10 years
Silva and White Coatings	10 years
Black Coatings	5 years
Aquaknight Easy Clean Wastes	7 years
Accessories	2 years

Warranty Exclusions

The product must be installed according to the instructions supplied.

The water supply temperature applied to the product must not exceed 55 degrees Celsius.

All cleaning and cleaning products must be in accordance with our cleaning instructions and guidance.

Commercial Applications (where products are installed in a building where occupancy is via a commercial arrangement i.e. a rental property, hotel, hostel etc) are restricted to a 2 year warranty on all products.



CLEANING AND MAINTENANCE

Please refer to our cleaning instructions document for guidance, available on our website.